

CUSTOM MILLWORK

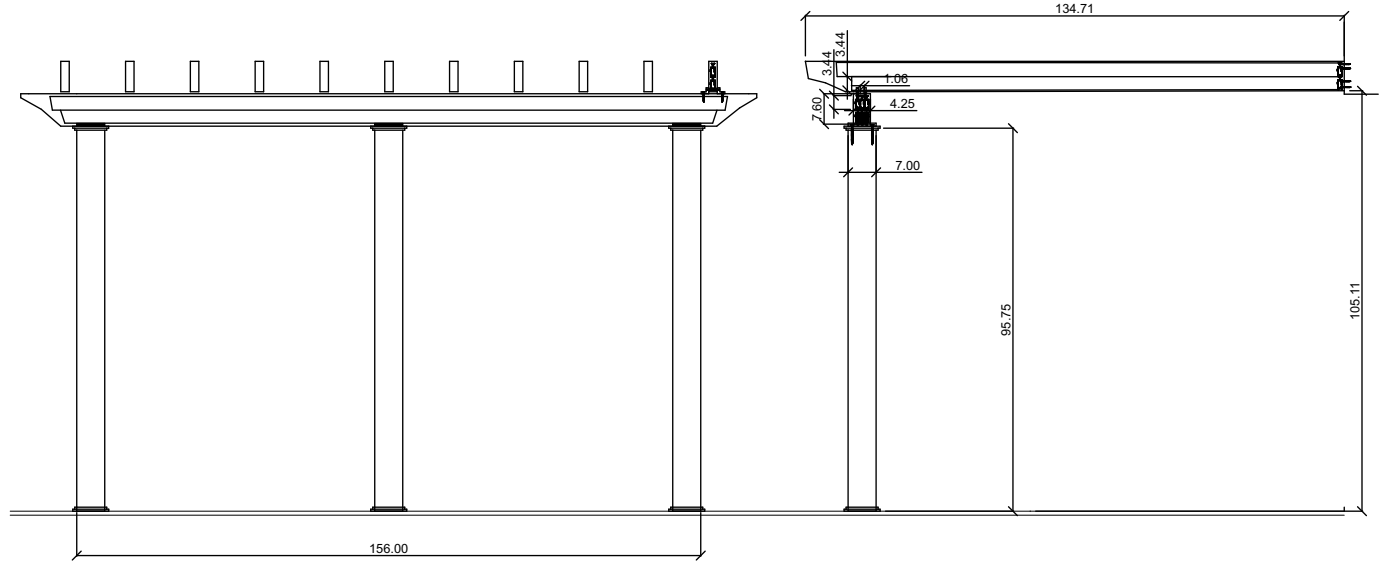

DETAIL PERSPECTIVE
SCALE: 1/4" = 1'-0"

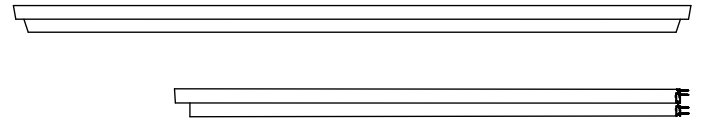
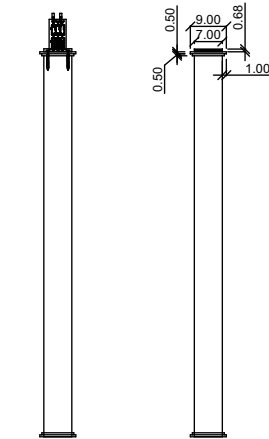

DETAIL PERSPECTIVE
SCALE: 1/4" = 1'-0"

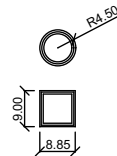

DETAIL PERSPECTIVE
SCALE: 1/4" = 1'-0"

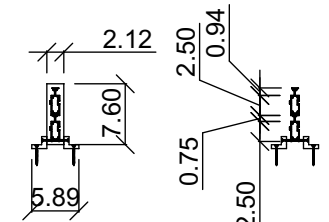

DETAIL PERSPECTIVE
SCALE: 1/2" = 1'-0"